



LEGAL DESCRIPTION  
COMBINED PARCEL 828536

THE EAST HALF OF THE SOUTHEAST QUARTER OF THE NORTHWEST QUARTER OF SECTION 30, TOWNSHIP 20 NORTH, RANGE 16 EAST, W.M., IN THE COUNTY OF KITTITAS, STATE OF WASHINGTON.

AND

LOT 1 AND LOT 2 OF LANIGAN SPRINGS (UNRECORDED), AS RECORDED IN BOOK 2 OF SURVEYS, AT PAGES 6 THROUGH 10, UNDER AUDITOR'S FILE NUMBER 397916, RECORDS OF KITTITAS COUNTY, STATE OF WASHINGTON.

EXCEPT THAT PORTION OF LOT 1 AND LOT 2 BOUNDED BY A LINE DESCRIBED AS FOLLOWS:

BEGINNING AT THE SOUTHWEST CORNER OF SAID LOT 1 WHICH IS THE TRUE POINT OF BEGINNING OF SAID LINE; THENCE NORTH 00°37'40" EAST ALONG THE WEST BOUNDARY LINE OF SAID LOT 1, 422.86 FEET; THENCE NORTH 88°19'09" EAST, 468.33 FEET; THENCE SOUTH 51°08'41" EAST, 156.06 FEET; THENCE SOUTH 00°57'27" EAST, 332.15 FEET TO A POINT ON THE SOUTH BOUNDARY LINE OF SAID LOT 2; THENCE SOUTH 89°22'23" WEST ALONG THE SOUTH BOUNDARY LINE OF SAID LOT 1 AND LOT 2, 599.87 FEET TO THE SOUTHWEST CORNER OF SAID LOT 1 WHICH IS THE TRUE POINT OF BEGINNING AND TERMINUS OF SAID LINE.

ALL SITUATED IN THE NORTH HALF OF SECTION 30, TOWNSHIP 20 NORTH, RANGE 16 EAST, W.M., KITTITAS COUNTY, STATE OF WASHINGTON.

CONTAINING 24.38 ACRES

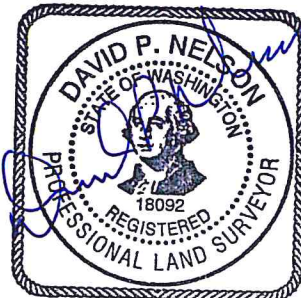

**Western Washington Division**

165 NE Juniper St., Ste 201, Issaquah, WA 98027  
98922

Phone: (425) 392-0250 Fax: (425) 391-3055  
674-7419

**Eastern Washington Division**

108 East 2<sup>nd</sup> Street, Cle Elum, WA

Phone: (509) 674-7433 Fax: (509)



LEGAL DESCRIPTION  
REVISED LOT 2

LOT 1 AND LOT 2 OF LANIGAN SPRINGS (UNRECORDED), AS RECORDED IN BOOK 2 OF SURVEYS, AT PAGES 6 THROUGH 10, UNDER AUDITOR'S FILE NUMBER 397916, RECORDS OF KITTITAS COUNTY, STATE OF WASHINGTON.

EXCEPT THAT PORTION OF LOT 1 AND LOT 2 BOUNDED BY A LINE DESCRIBED AS FOLLOWS:

BEGINNING AT THE SOUTHWEST CORNER OF SAID LOT 1 WHICH IS THE TRUE POINT OF BEGINNING OF SAID LINE; THENCE NORTH 00°37'40" EAST ALONG THE WEST BOUNDARY LINE OF SAID LOT 1, 422.86 FEET; THENCE NORTH 88°19'09" EAST, 468.33 FEET; THENCE SOUTH 51°08'41" EAST, 156.06 FEET; THENCE SOUTH 00°57'27" EAST, 332.15 FEET TO A POINT ON THE SOUTH BOUNDARY LINE OF SAID LOT 2; THENCE SOUTH 89°22'23" WEST ALONG THE SOUTH BOUNDARY LINE OF SAID LOT 1 AND LOT 2, 599.87 FEET TO THE SOUTHWEST CORNER OF SAID LOT 1 WHICH IS THE TRUE POINT OF BEGINNING AND TERMINUS OF SAID LINE.

ALL SITUATED IN THE NORTH HALF OF SECTION 30, TOWNSHIP 20 NORTH, RANGE 16 EAST, W.M., KITTITAS COUNTY, STATE OF WASHINGTON.

CONTAINING 5.90 ACRES



**Western Washington Division**  
165 NE Juniper St., Ste 201, Issaquah, WA 98027  
98922  
Phone: (425) 392-0250 Fax: (425) 391-3055  
674-7419

**Eastern Washington Division**  
108 East 2<sup>nd</sup> Street, Cle Elum, WA  
Phone: (509) 674-7433 Fax: (509)





LEGAL DESCRIPTION  
REVISED LOT 1

THAT PORTION OF LOT 1 AND LOT 2 OF LANIGAN SPRINGS (UNRECORDED), AS RECORDED IN BOOK 2 OF SURVEYS, AT PAGES 6 THROUGH 10, UNDER AUDITOR'S FILE NUMBER 397916, RECORDS OF KITTITAS COUNTY, STATE OF WASHINGTON WHICH IS BOUNDED BY A LINE DESCRIBED AS FOLLOWS:

BEGINNING AT THE SOUTHWEST CORNER OF SAID LOT 1 WHICH IS THE TRUE POINT OF BEGINNING OF SAID LINE; THENCE NORTH 00°37'40" EAST ALONG THE WEST BOUNDARY LINE OF SAID LOT 1, 422.86 FEET; THENCE NORTH 88°19'09" EAST, 468.33 FEET; THENCE SOUTH 51°08'41" EAST, 156.06 FEET; THENCE SOUTH 00°57'27" EAST, 332.15 FEET TO A POINT ON THE SOUTH BOUNDARY LINE OF SAID LOT 2; THENCE SOUTH 89°22'23" WEST ALONG THE SOUTH BOUNDARY LINE OF SAID LOT 1 AND LOT 2, 599.87 FEET TO THE SOUTHWEST CORNER OF SAID LOT 1 WHICH IS THE TRUE POINT OF BEGINNING AND TERMINUS OF SAID LINE.

ALL SITUATED IN THE NORTH HALF OF SECTION 30, TOWNSHIP 20 NORTH, RANGE 16 EAST, W.M., KITTITAS COUNTY, STATE OF WASHINGTON.

CONTAINING 5.70 ACRES

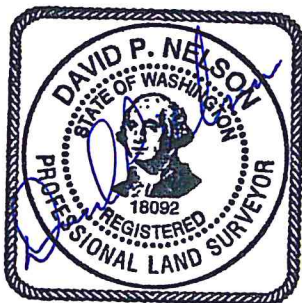

09/29/2014

---

**Western Washington Division**

165 NE Juniper St., Ste 201, Issaquah, WA 98027  
98922

Phone: (425) 392-0250 Fax: (425) 391-3055  
674-7419

**Eastern Washington Division**

108 East 2<sup>nd</sup> Street, Cle Elum, WA

Phone: (509) 674-7433 Fax: (509)